



FUEL LEVEL SENSORS: Lever-type level sensor



Lever-type level sensor

Lever-type level sensors are used in many vehicles and machines to record the current tank contents and to forward the evaluation result to the tank display. A float always moves on the surface of the liquid and, in so doing, changes the resistance value in the tank sensor.

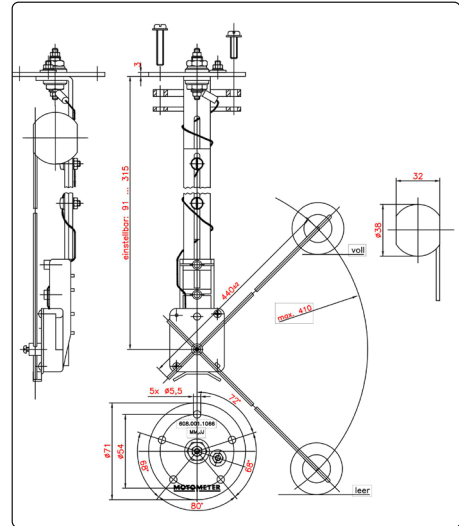

**Example Drawing of a
lever-type level sensor**

MOTOMETER lever-type level sensors are suitable for Diesel and gasoline fuels and are available in different versions. Operation is possible with an onboard 12 Volt or 24 Volt systems. The resistance with "Tank Full" is 180 Ohm and with "Tank Empty" 3 Ohm. The version is grounded.

Compatible with MOTOMETER fuel displays:

609 060 xxxx

Part No.	Diameter hole circle	Length	Feature
608 001 1066	54 mm	150 - 600 mm	adjustable
608 002 1001	54 mm	150 - 600 mm	adjustable, ceramics plate

Special wishes? We deliver customized solutions!

In addition to the standard temperature sensors listed, we can also offer you customized specific solutions. Simply contact us with your requirements via the adjacent button:

MOTOMETER

MOTOMETER GmbH

Fritz-Neuert-Straße 27 | 75181 Pforzheim/Germany
Phone +49 7231 42909-300 | **Fax** +49 7231 42909-305
E-Mail info@motometer.de | www.motometer.de